

MIL-C-39012/56\*

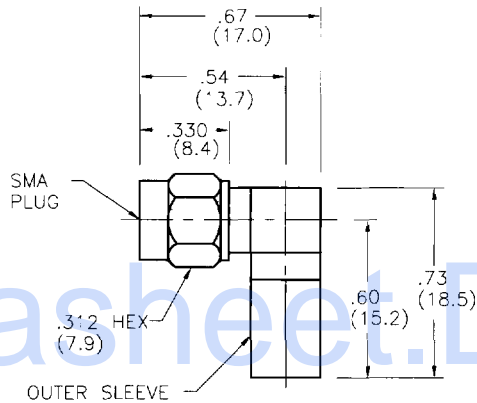

FIGURE 1

MILITARY PART NO.	MIDWEST PART NO.	FIGURE	ASSEMBLY PROCEDURE	CATEGORY	CABLE TYPE	COMMERCIAL ALTERNATE
- 3006	M39012/56-3006	1	SMA -028	A	I	SMA-0196-56-000-02
- 3007	M39012/56-3007	1	SMA -028	A	II	SMA-0188-56-000-02
- 3008	M39012/56-3008	1	SMA -028	A	III	SMA-0122-56-000-02
- 3009	M39012/56-3009	1	SMA -028	A	IV	SMA-0142-56-000-02
- 3010	M39012/56-3010	1	SMA -028	A	V	SMA-0142-56-000-02
- 3025	M39012/56-3025	1	SMA -028	C	I	SMA-1196-56-000-02
- 3026	M39012/56-3026	1	SMA -028	C	II	SMA-1188-56-000-02
- 3027	M39012/56-3027	1	SMA -028	C	III	SMA-1122-56-000-02
- 3028	M39012/56-3028	1	SMA -028	C	IX	SMA-1055-56-000-02
- 3029	M39012/56-3029	1	SMA -028	C	X	SMA-1058-56-000-02
- 3106	M39012/56-3106	1	SMA -028	A	I	SMA-0196-56-000-02
- 3107	M39012/56-3107	1	SMA -028	A	II	SMA-0188-56-000-02
- 3108	M39012/56-3108	1	SMA -028	A	III	SMA-0122-56-000-02
- 3109	M39012/56-3109	1	SMA -028	A	IV	SMA-0142-56-000-02
- 3110	M39012/56-3110	1	SMA -028	A	V	SMA-0142-56-000-02
- 3125	M39012/56-3125	1	SMA -028	C	I	SMA-1196-56-000-02
- 3126	M39012/56-3126	1	SMA -028	C	II	SMA-1188-56-000-02
- 3127	M39012/56-3127	1	SMA -028	C	III	SMA-1122-56-000-02
- 3128	M39012/56-3128	1	SMA -028	C	IX	SMA-1055-56-000-02
- 3129	M39012/56-3129	1	SMA -028	C	X	SMA-1058-56-000-02

**Notes:**

1. Coupling nut is passivated and lockwire safety holes are not used on - 3100 series part numbers.
2. Connector housings are gold plated for soldering of cable outer conductor (Mil-C-39012/55D Amendment 1, Note 9).
3. Category A: solder sleeve; Categories B, C, and D: crimp sleeve.
4. See Appendix for description of connector interfaces, categories and cable types.
5. \*Qualification for MIL-C-39012/56 was in process at time of printing, please contact Midwest Microwave for current status.