

### Panel Mount Female Jack - Solder Pot Type

Model Number

TNC-5740-15-POT-02

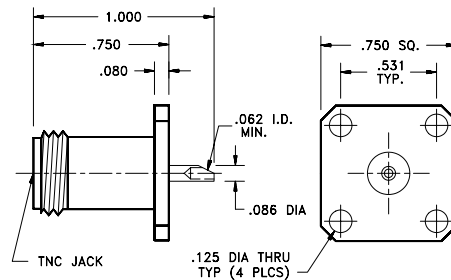

Note: Standard finish is Passivated Stainless Steel.

### Panel Mount Female Jack - Terminal Type

Model Number

TNC-5710-15-TRM-02

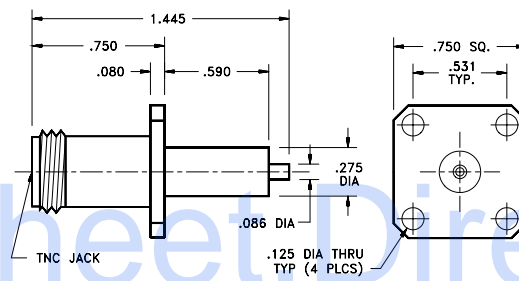

Note: Standard finish is Passivated Stainless Steel.

### Panel Mount Female Jack - Tab Terminal Type

Model Number

TNC-5730-15-TAB-02

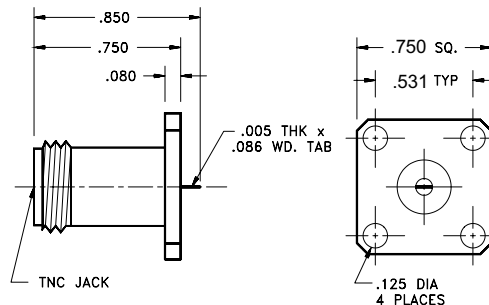

Note: Standard finish is Passivated Stainless Steel.

### Bulkhead Female Jack - Front Mount

Model Number

TNC-5040-12-POT-02

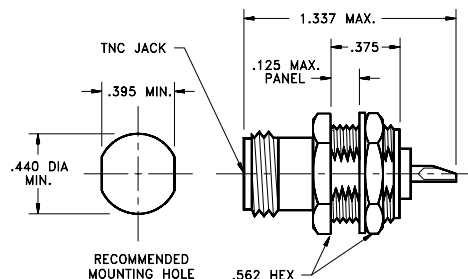

Note: Standard finish is Passivated Stainless Steel. Detail interface dimensional information can be found in the appendix.